

10/10/20

10/10/20

10/10/20

10/10/20

10/10/20

10/10/20

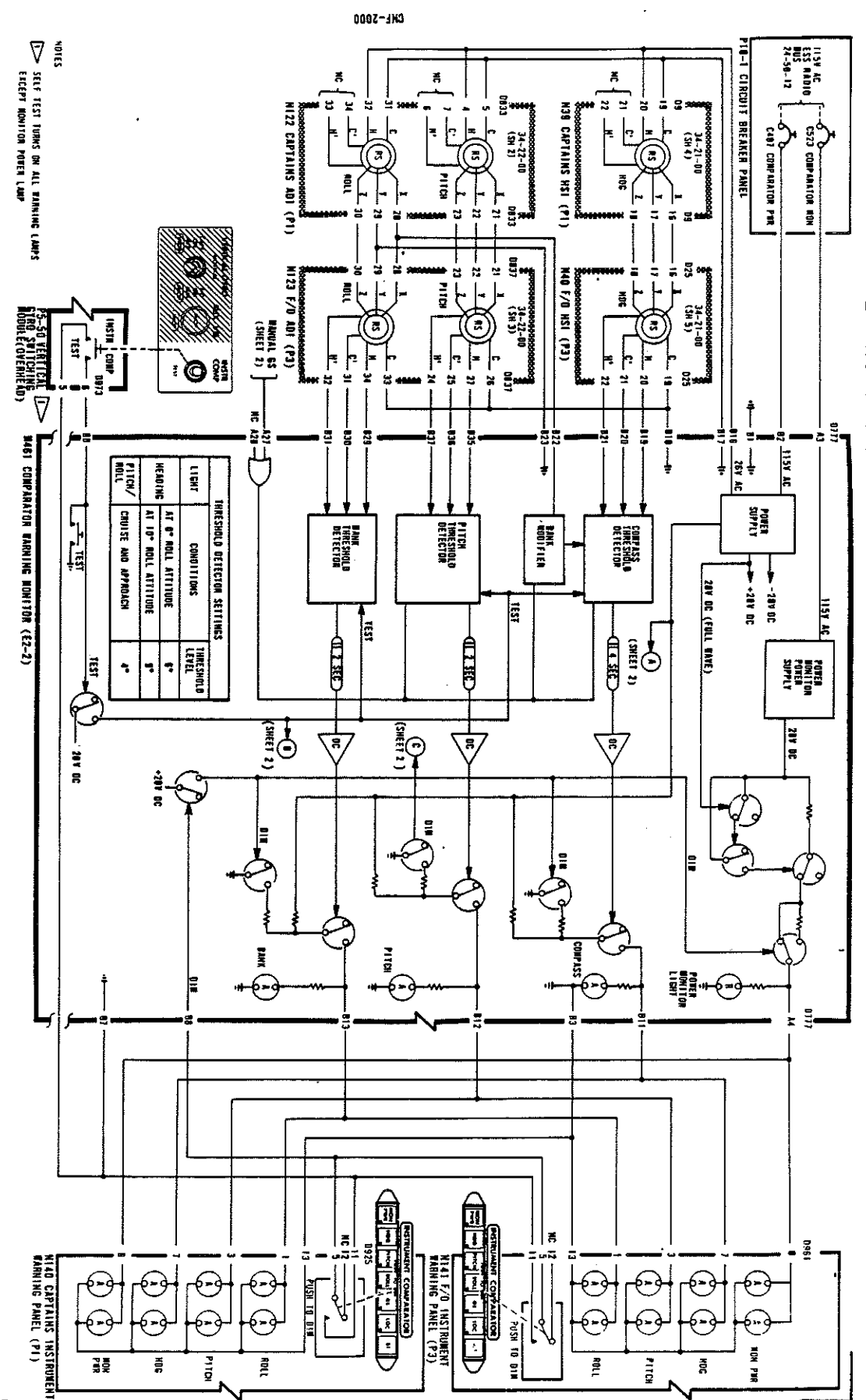

NOTES
 ▲ SELF TEST LAMPS ON ALL WARNING LAMPS
 ▲ EXCEPT MONITOR POWER LAMP

STANDARD 127 INSTRUMENT COMPARETOR SYSTEM

DRAWING NO: 94-427M
 DATE: 28 SEP 78
 CON: 34-33-00
 CHANGE: 1

34-33-00
 PAGE 101
 SHEET 1

34-33-00
 PAGE 101
 SHEET 1

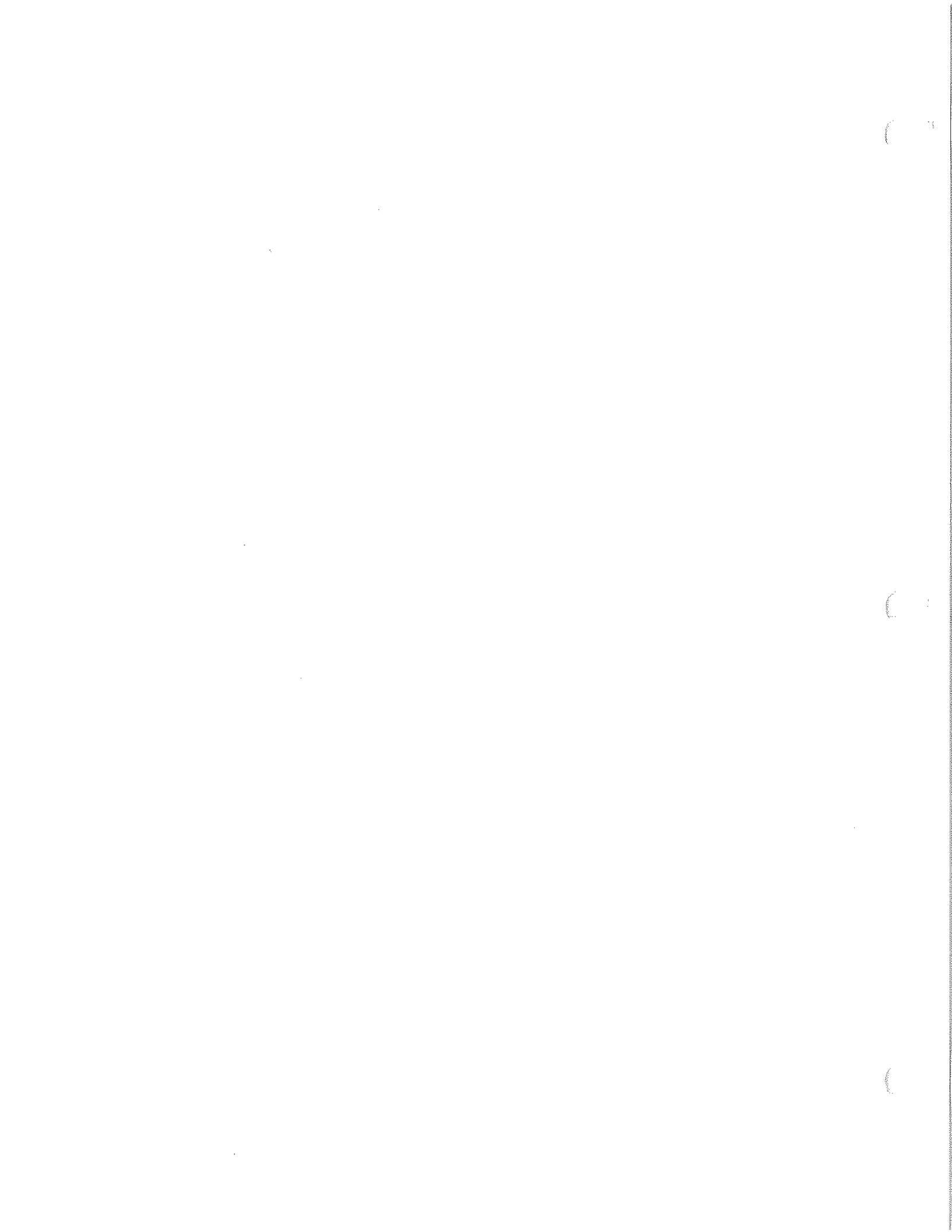

BOEING 727 SCHEMATIC

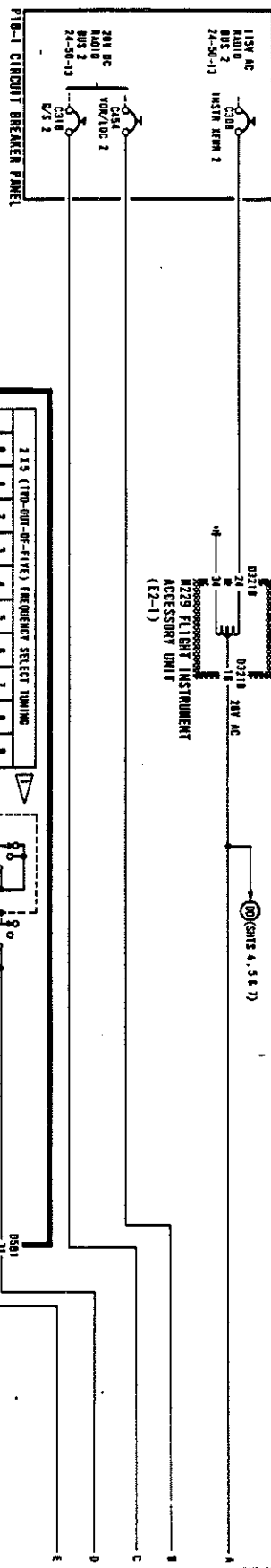

215 (TEN-ONE-FIVE) FREQUENCY SELECT TUNING

	0	1	2	3	4	5	6	7	8	9
A		X	X	X	X	X	X	X	X	X
B	X		X	X	X	X	X	X	X	X
C				X	X	X	X	X	X	X
D					X	X	X	X	X	X
E	X									

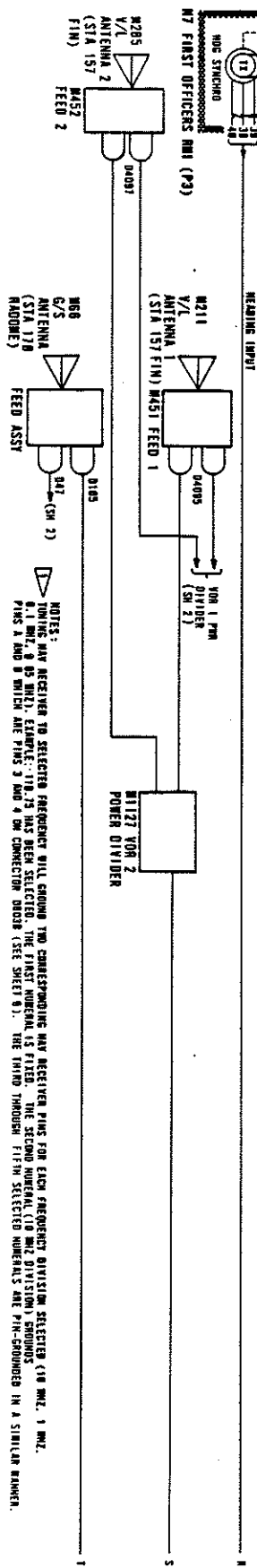
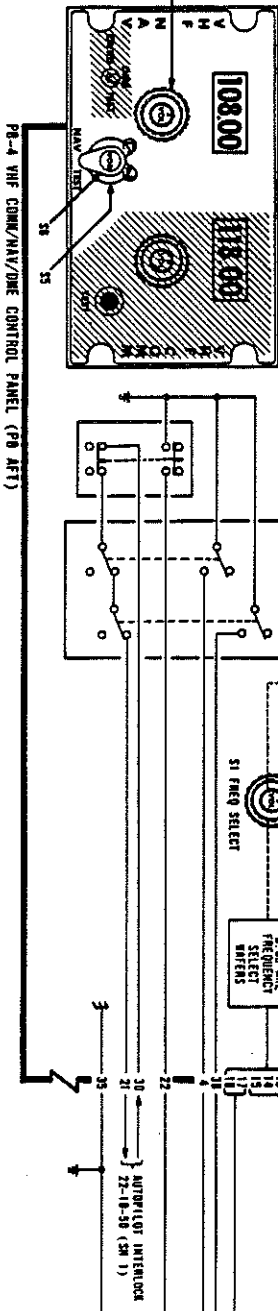

NOTES:
 1. DOWN HAS RECEIVED TO SELECTED FREQUENCY WILL GROUND TWO CORRESPONDING MAIN RECEIVERS PLUS FOR EACH FREQUENCY DIVISION SELECTED (10 MHZ, 1 MHZ, 0.1 MHZ, AND 0.5 MHZ).
 2. THE FIRST FREQUENCY SELECTED WILL BE THE FIRST FREQUENCY SELECTED. THE SECOND FREQUENCY SELECTED WILL BE THE SECOND FREQUENCY SELECTED. THE THIRD THROUGH FIFTH SELECTED FREQUENCIES WILL BE THE THIRD THROUGH FIFTH SELECTED FREQUENCIES IN A SIMILAR MANNER.

CMF-2000

BOEING 721 SCHEMATIC

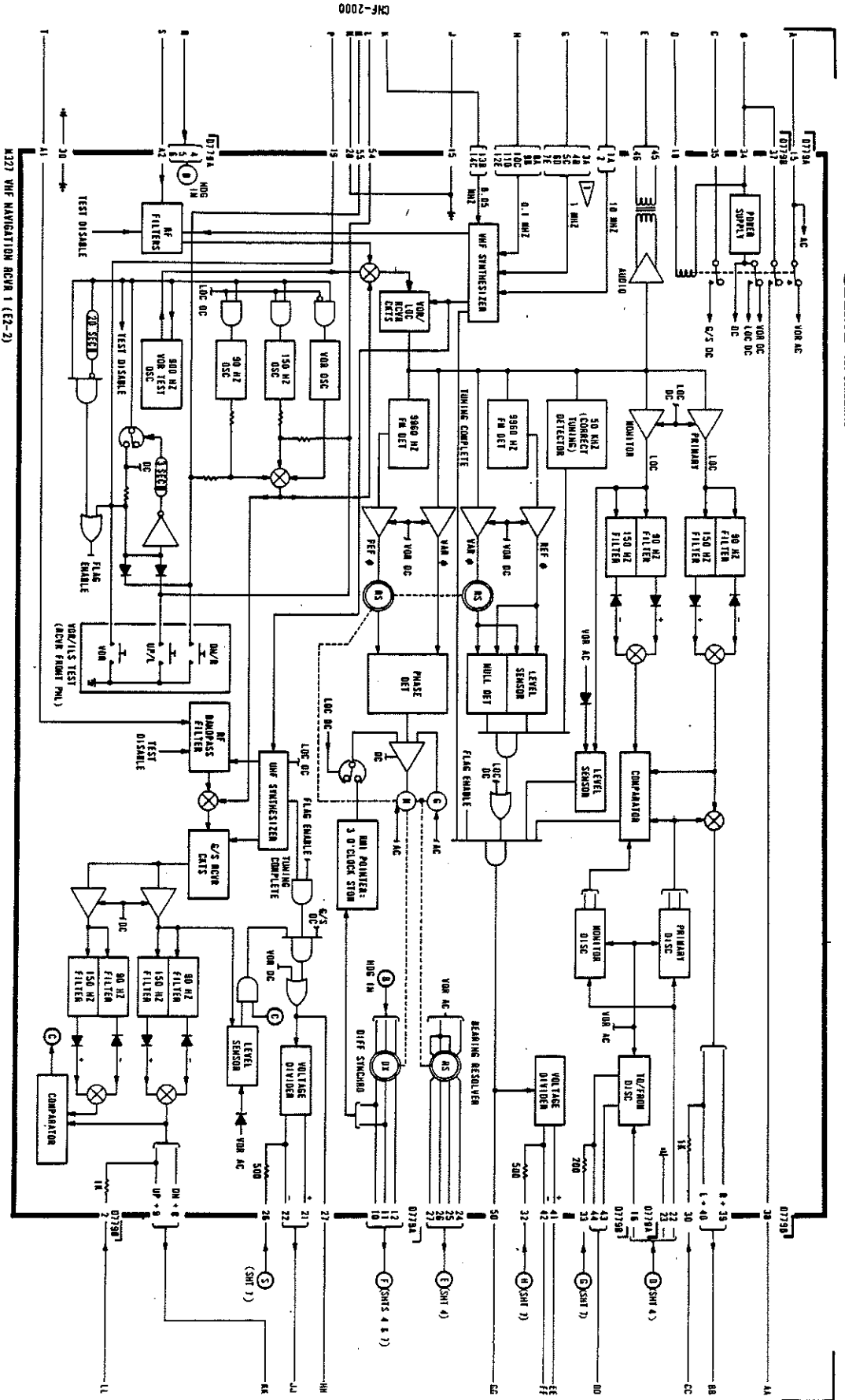

STANDARD 721 VHF NAVIGATION SYSTEM

ORIGIN: MR. DR. 0721 34-31-00
 PAGE DATE: SEP 20/72
 CHANGE: PAGE 101
 SHEET 3

34-31-00
 PAGE 101
 SHEET 3

34-31-00 SCHEMATIC

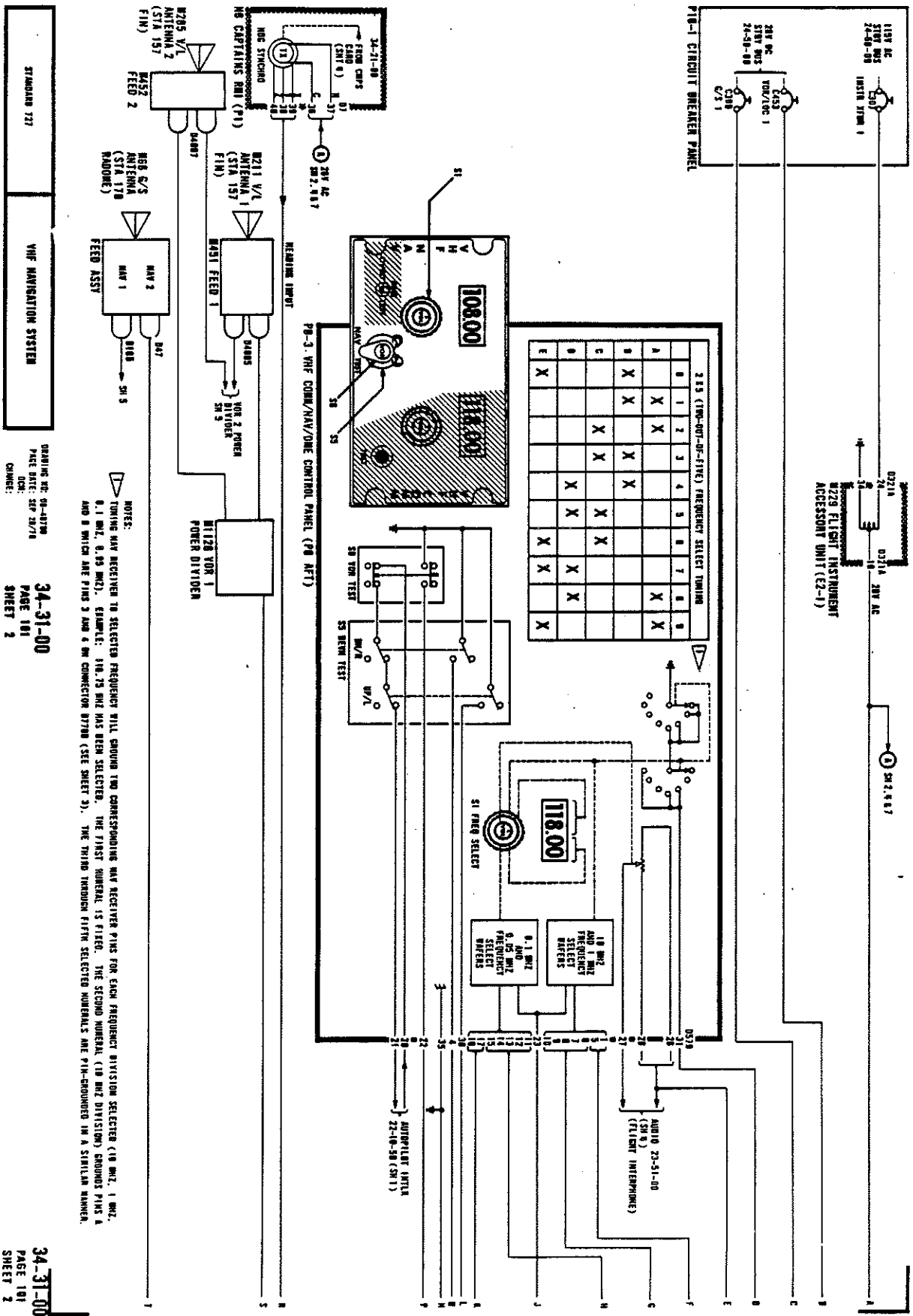

STANDARD 727

VHF NAVIGATION SYSTEM

DRAWING NO: 34-31-00
 PAGE ONE
 SHEET 2

34-31-00
 PAGE 101
 SHEET 2

34-31-00
 PAGE 101
 SHEET 2

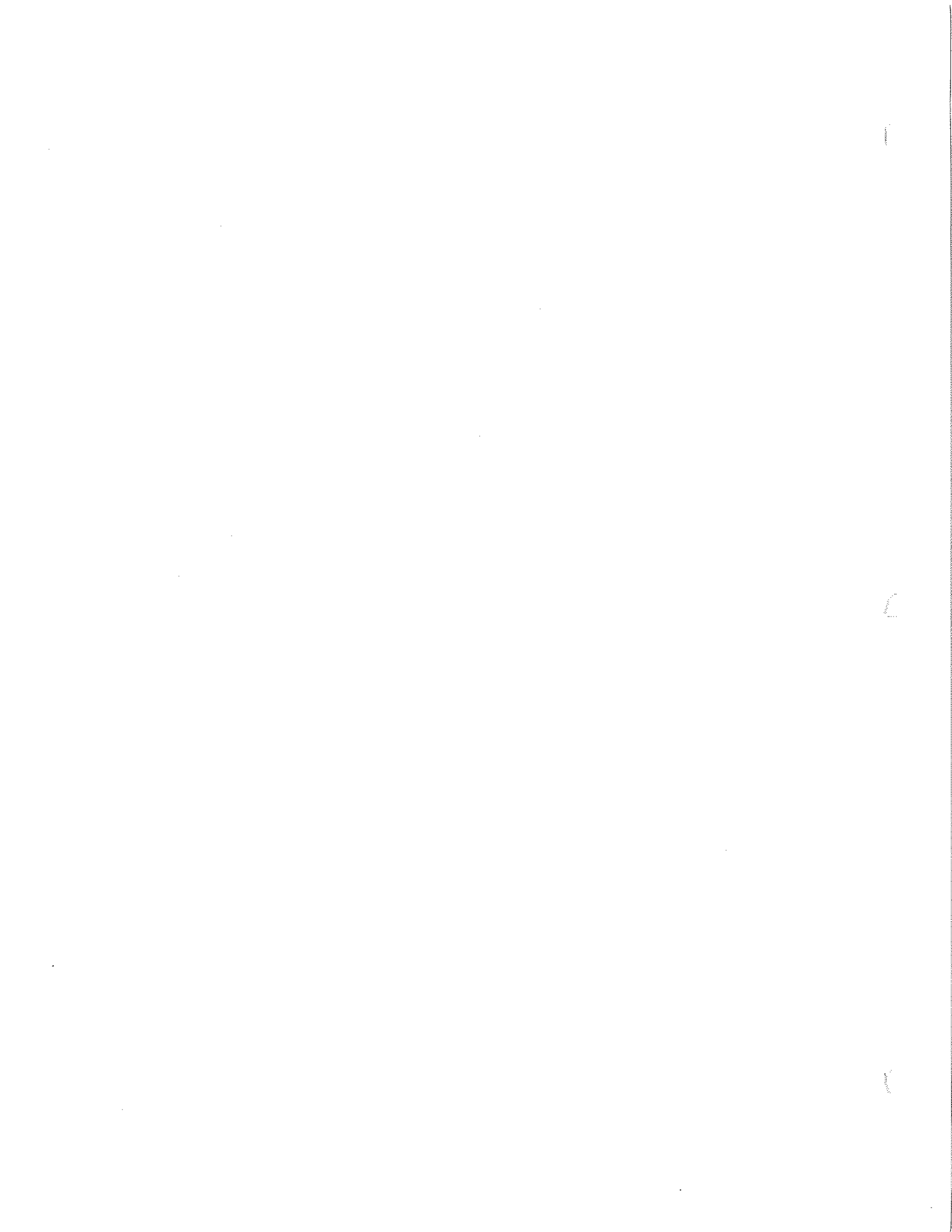

BOEING 721 SCHEMATIC

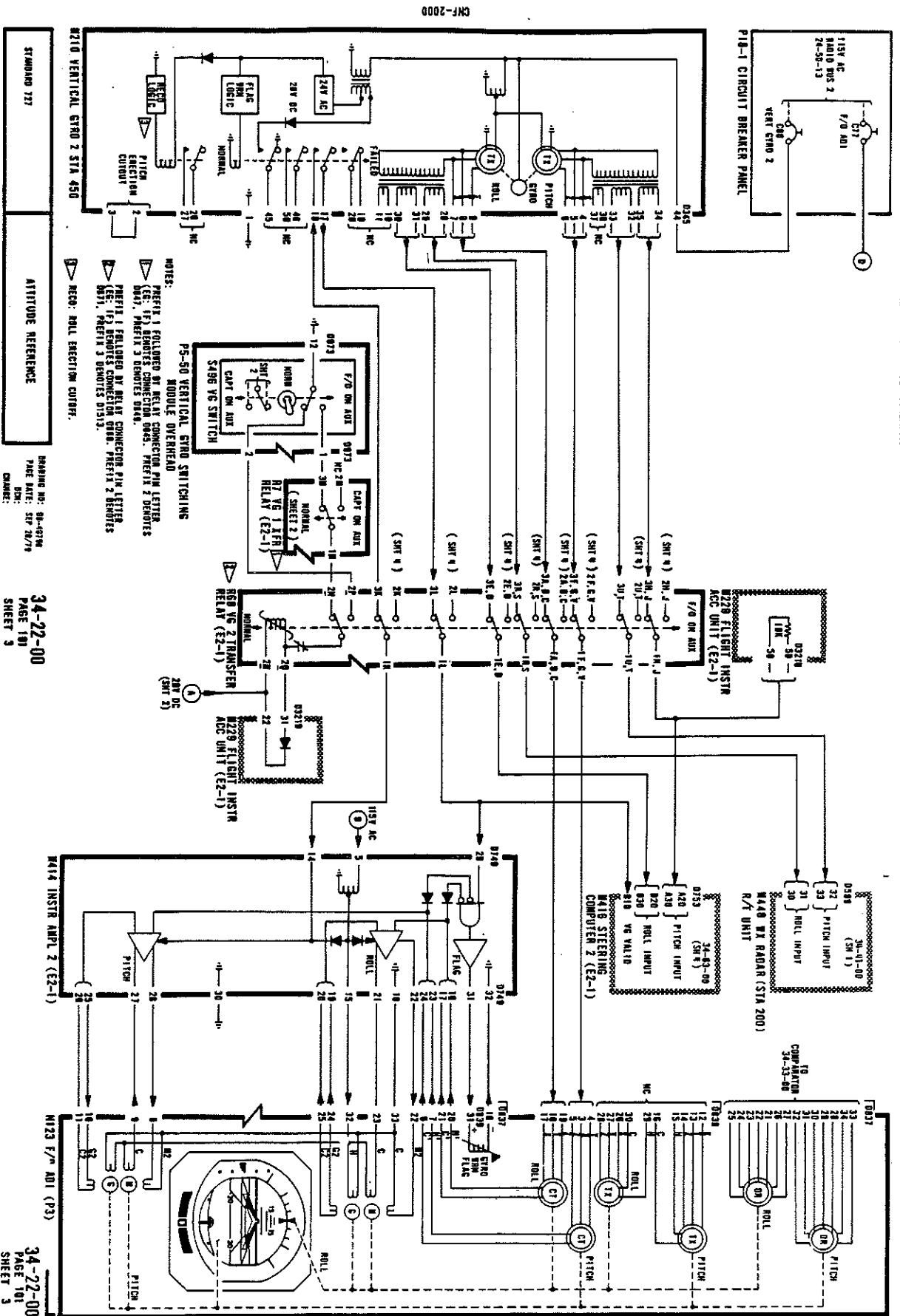

NOTES:
 PREFIX 1 FOLLOWED BY RELAY CONNECTION PIN LETTERS
 (SEE: P18 DEMOTES CONNECTION 0445. PREFIX 2 DEMOTES
 0467. PREFIX 3 DEMOTES 0468.
 PREFIX 1 FOLLOWED BY RELAY CONNECTION PIN LETTERS
 (SEE: P18 DEMOTES CONNECTION 0445. PREFIX 2 DEMOTES
 0467. PREFIX 3 DEMOTES 0468.)
 PREFIX 1 FOLLOWED BY RELAY CONNECTION PIN LETTERS
 (SEE: P18 DEMOTES CONNECTION 0445. PREFIX 2 DEMOTES
 0467. PREFIX 3 DEMOTES 0468.)
 PREFIX 1 FOLLOWED BY RELAY CONNECTION PIN LETTERS
 (SEE: P18 DEMOTES CONNECTION 0445. PREFIX 2 DEMOTES
 0467. PREFIX 3 DEMOTES 0468.)

DRAWING NO: 34-22-00
 PAGE 101
 SHEET 3

34-22-00
 PAGE 101
 SHEET 3

REFERENCE 121 SCHEMATIC

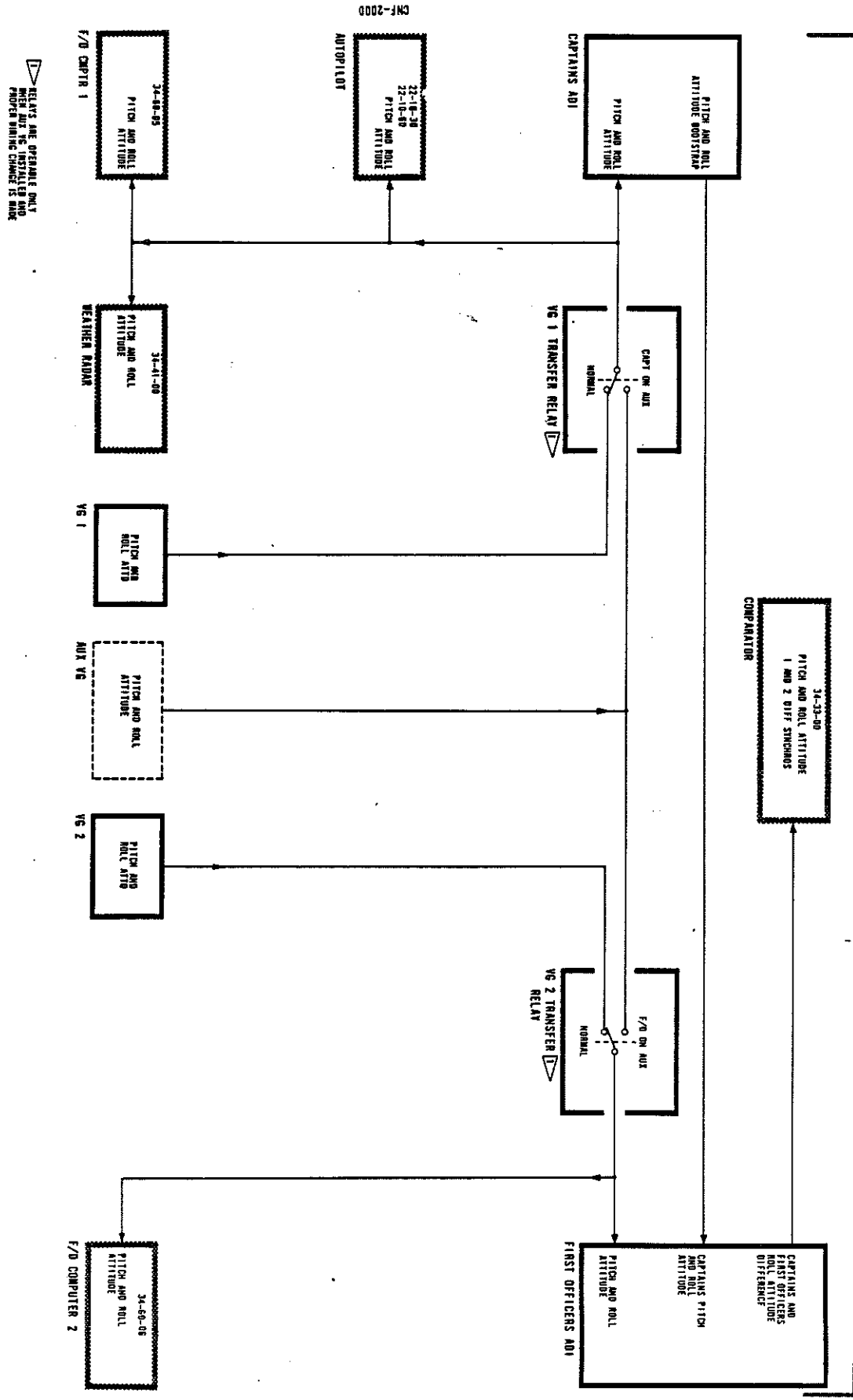

RELAYS ARE OPERABLE ONLY WHEN ADI IS INSTALLED AND PROPER WIRING CHANGE IS MADE

STANDARD 721 ATTITUDE REFERENCE

DRIVING IN: 82-4/78
 VISE DATE: 5/7 7/78
 DOC: CHANGE:

34-72-00
 PAGE 101
 SHEET 1

34-72-00
 PAGE 101
 SHEET 1

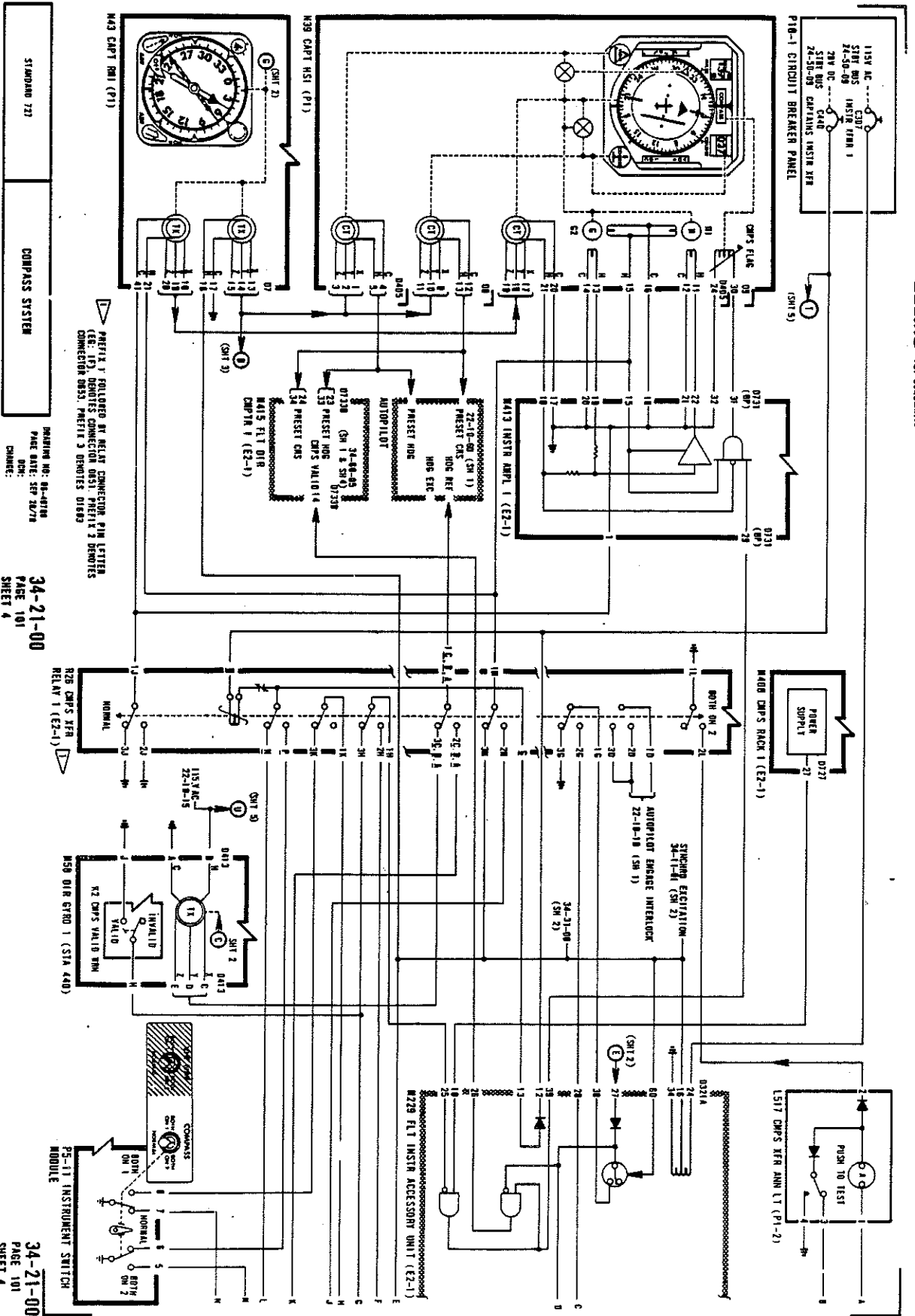

STANDARD 727

COMPASS SYSTEM

ORIGIN: 08-04-61M
PAGE DATE: SEP 20/74
CHANG:

34-21-00
PAGE 101
SHEET 4

34-21-00
PAGE 101
SHEET 4

